

# 1 Step CLUTCH MOTOR ,1 Step DRAIN MOTOR

1단 CLUTCH MOTOR

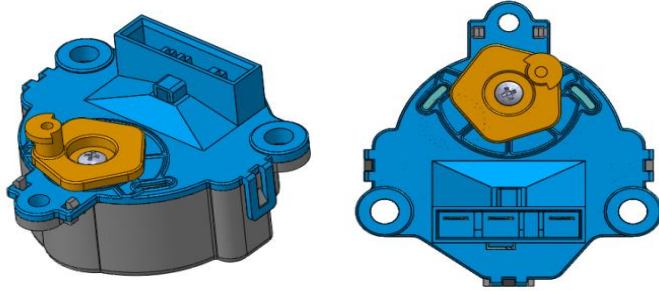

1단 DRAIN MOTOR

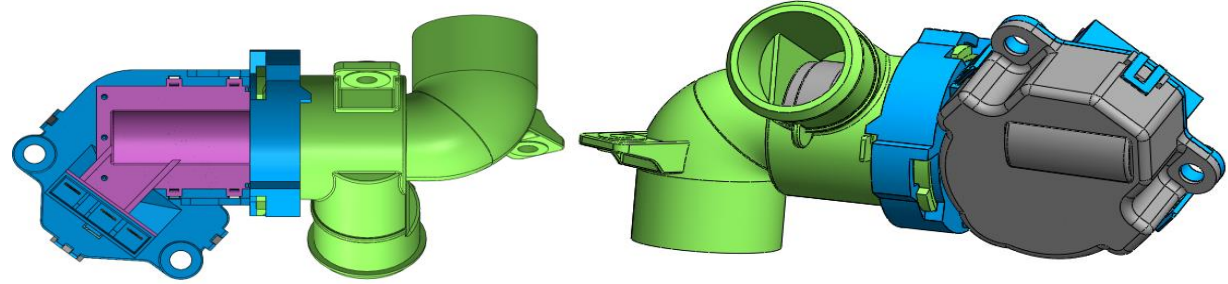

## ● FEATURES

Receiving Signal from Washing, pulstator driving in washing mode, transmitted power in Dry-spin mode,  
Using DC Motor, decrease power consumption, Fire Hazard.(CLUTCH MOTOR)  
Open/Close Drain by receiving Washing machine signal(Washing, Dry-spin mode)  
Using DC Motor, decrease power consumption, Fire Hazard.(DRAIN MOTOR)

## ● USAGE

Power transmission and release of washing machine (drum) and pulstator (washing plate) (1 Step Clutch Motor)  
Open/Close drain when is complete washing mode, (DRAIN MOTOR)

## SPECIFICATION

Model	SIZE (mm)	Motor	Rating	Torque
SDAB	75.2 X 80.9 X 47.7	DC MOTOR	DC 13.5V	3.6 kgf.cm
SDAC	176.3X 85.2 X 97.2	DC MOTOR	DC 13.5V	3.6 kgf.cm